

WOOD HOLLOW

PINEVIEW | 39102

APPROX. 3,226 SQ. FT. | 1,610 SQ. FT. | RAMBLER
3 BEDROOMS | 2 BATHROOMS | 2 to 3 BAY GARAGE



ELEVATION S



ELEVATION A



ELEVATION B



ELEVATION C

CenturyCommunities.com/Utah | 801.653.3536

A HOME FOR
EVERY DREAMSM



Price, plans and terms are effective on the date of publication and subject to change without notice. Depictions of homes or other features are conceptual. Decorative items and other items shown may be decorator suggestions that are not included in the purchase price and availability may vary. Persons in photos do not reflect racial preference and housing is open to all without regard to race, color, religion, sex, handicap, familial status, or national origin. ©2019 Century Communities.

WOOD HOLLOW

PINEVIEW | 39102

APPROX. 3,226 SQ. FT. | 1,610 SQ. FT. | RAMBLER
3 BEDROOMS | 2 BATHROOMS | 2 to 3 BAY GARAGE

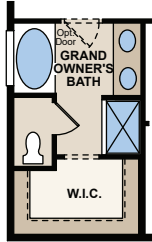

OPT. GRAND OWNER'S
BATH

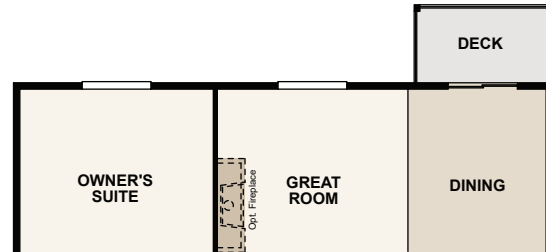

OPT. WALKOUT MAIN FLOOR PLAN

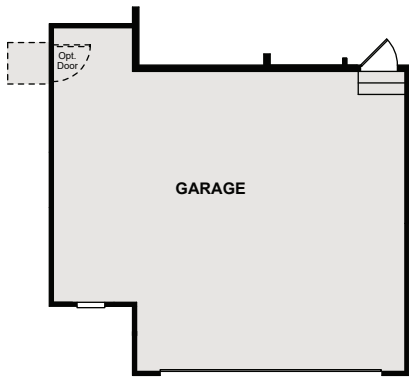

OPT. EXTENDED GARAGE

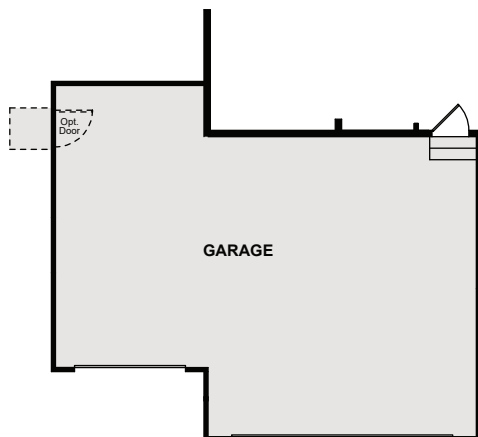

OPT. 3RD BAY GARAGE



FIRST FLOOR

CenturyCommunities.com/Utah | 801.653.3536

A HOME FOR
EVERY DREAMSM



Price, plans and terms are effective on the date of publication and subject to change without notice. Depictions of homes or other features are conceptual. Decorative items and other items shown may be decorator suggestions that are not included in the purchase price and availability may vary. Persons in photos do not reflect racial preference and housing is open to all without regard to race, color, religion, sex, handicap, familial status, or national origin. ©2019 Century Communities.